

HmIP-SWD-2

Water Sensor



Installation instructions and
operating manual

homematic 

Table of contents

1 Package contents.....	3
2 Information about this manual.....	3
3 Hazard information.....	3
4 Function and device overview.....	5
5 General system information.....	5
6 Start-up.....	6
6.1 Pairing with a central control unit.....	6
6.2 Installation site.....	6
7 Replacing batteries.....	7
8 Troubleshooting.....	8
8.1 Command not confirmed.....	8
8.2 Duty cycle.....	8
8.3 Flash codes.....	9
9 Restoring the factory settings.....	10
10 Maintenance and cleaning.....	10
11 General information about wireless operation.....	10
12 Disposal.....	11
13 Technical specifications.....	12

Documentation © 03/2025 eQ-3 AG, Germany

All rights reserved. No part of this manual may be reproduced in any form or duplicated or processed using electronic, mechanical or chemical processes without the written consent of the publisher.

It is possible that this manual may contain typographical errors or printing errors. However, the information contained in this manual is reviewed on a regular basis and any necessary corrections will be implemented in the next edition. We accept no liability for technical or typographical errors or the consequences thereof. All trademarks and industrial property rights are acknowledged.

Changes in line with technical progress may be made without prior notice.

Version 1.7



1 Package contents

- 1x Water Sensor
- 2x 1,5 V LR03/Mignon/AAA Batteries
- 1x Operating manual









2 Information about this manual

Read this manual carefully before beginning operation with your Homematic IP device. Keep the manual for later consultation. If you hand the device over to other persons for use, please ask them to read this manual.

Symbols used

-  This indicates a hazard.
-  This section contains important additional information.

3 Hazard information

-  We accept no liability for damage caused by use for other than the intended purpose, incorrect handling or failure to observe the hazard warnings. In such cases, all warranty claims are void. We accept no liability for consequential damage.
-  Do not use the device if it has visible damage or a malfunction. If you have any doubts, have the device checked by a qualified expert.
-  For safety and licensing reasons (CE), unauthorised conversions to and/or modification of the device are not permitted.
-  The device is not a toy – do not allow children to play with it.
-  Plastic film, plastic bags, polystyrene parts, etc. can be dangerous for children. Keep the packaging material out of the reach of children and dispose of it immediately.
-  Do not expose the device to moisture, vibrations, constant solar or other heat radiation, excessive cold or mechanical loads. The device may only be operated indoors or a protected outdoor area, in compliance with the conditions of use specified in the technical data.
-  Ensure that the batteries are replaced correctly. Only replace the batteries with the same or an equivalent type. Do not dispose of the batteries in a fire. Do not expose the batteries to excessive temperatures. Do not short circuit the batteries. Doing so will present a risk of explosion.
-  Leaking or damaged batteries can cause chemical burns on contact with skin. Wear suitable protective gloves when handling or replacing leaking or damaged batteries. Avoid contact with leaked liquids. In case of skin contact, rinse with plenty of water.
-  Do not open the device. You do not have to perform any maintenance on the device apart from any necessary battery changes. Repairs may only be carried out by a qualified specialist.

 Do not expose the device to moisture, vibrations, constant solar or other heat radiation, excessive cold or mechanical loads. The device must only be operated indoors.

 Clean the device using a soft and dry lint-free cloth. The cloth can be slightly moistened with lukewarm water to remove more stubborn marks. Do not use solvent-based cleaning agents for cleaning, as these can damage plastic parts and labelling.

4 Function and device overview

The Homematic IP Water Sensor offers reliable detection of moisture on various surfaces and water above a height of 1.5 mm. The presence of moisture or water is signalled immediately by the integrated siren and displayed in the Homematic IP app. What's more, the integrated tilt sensor even provides instant feedback in the event of the water sensor being moved or manipulated. The flexible device can be adapted to any installation site thanks to its battery operation and test prods mounted on spring bearings. The sensitivity and trigger behaviour of the water sensor can be individually adjusted using the Homematic IP app.

Device overview

- A) System button (teach-in button and LED)
- B) Siren
- C) Cap
- D) Battery compartment
- E) Electronic unit
- F) Test prods/bases

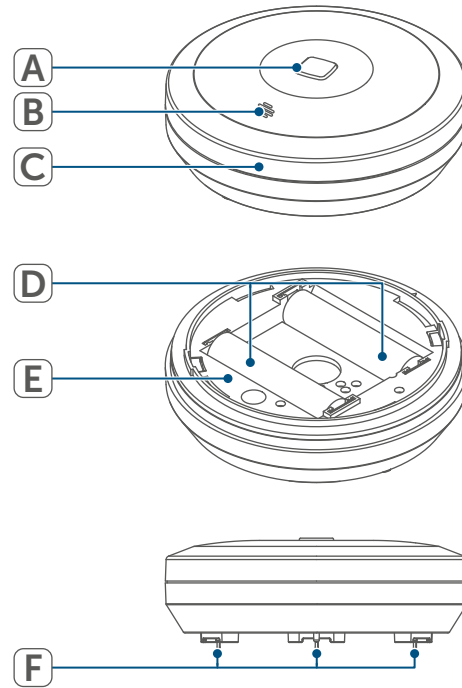

Figure 1

5 General system information

This device is part of the Homematic IP smart home system and communicates via the Homematic IP radio protocol. The device can be paired directly with one or more Homematic IP devices in order to control them directly (push-to-pair). Alternatively, the device can be paired with a control unit and configured via the Homematic IP app. All devices of the system can be configured comfortably and individually using the Homematic IP app. Operation requires the connection to a Homematic IP Access Point or control unit. Further information about the system and how to combine it with other Homematic IP devices can be found in the Homematic IP [User guide](#).

All technical documents and updates are to be found at www.homematic-ip.com.

6 Start-up

i We recommend that you first pair the device if you wish to put several devices into operation at the same time or if the installation location of the device is difficult to access.

6.1 Pairing with a central control unit

i Read this entire section before starting the pairing procedure.

i Set up your Homematic IP control unit via the Homematic IP app so that you can use Homematic IP devices in the system. Detailed information on this is to be found in the operating manual for the control unit.

Proceed as follows to pair the device with your control unit:

- Open the Homematic IP app.
- Tap on **...More** in the homescreen.
- Tap on **Pair device**.
- Remove the insulation strip from the battery compartment.
- The pairing mode is active for 3 minutes.

i You can manually start the pairing mode for another 3 minutes by pressing the system button shortly.

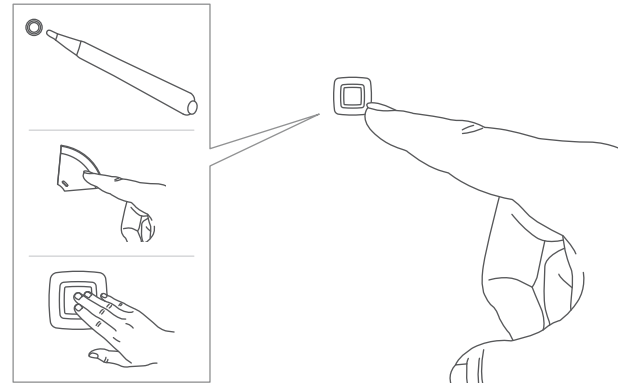

Figure 2

i The type of system button depends on your device. Further information is to be found in the device overview.

- The device appears automatically in the Homematic IP app.
- Enter the last four digits of the device number (SGTIN) in your app, or scan the QR code. The device number can be found on the sticker supplied or attached to the device.
- Wait until pairing is completed.
- If pairing was successful, the device LED lights up green.
- The device is now ready for use.

i If the device LED lights up red to, please try again [Flash codes, page 9](#).

- Then follow the instructions in the Homematic IP app.

6.2 Installation site

Once you have completed the teach-in process, you can easily set up the water sensor at the installation site of your choice (for example, next to a washing machine or underneath a drainpipe).

i When mounting the water detector, please ensure that it is not installed directly on top of – or in the vicinity of – large metal objects (such as heaters or aluminium clad walls), as this would reduce the wireless range.

7 Replacing batteries

If an empty battery is displayed via the app or the device ([see Flash codes, page 9](#)), replace the used batteries by two new LR3/micro/ AAA batteries. You must observe the correct battery polarity.

To replace the batteries of the water sensor, please proceed as follows:

- Open the battery compartment by rotating the cap and electronic unit away from each other and removing the cover.

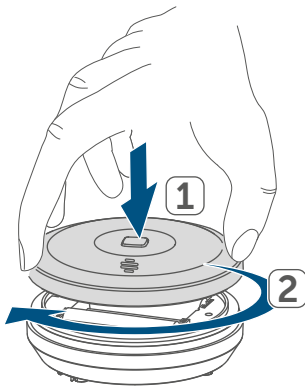

Figure 3

Remove the empty batteries. Insert two new 1.5 V LR03/micro/AAA batteries into the battery compartment, making sure that you insert them the right way round.

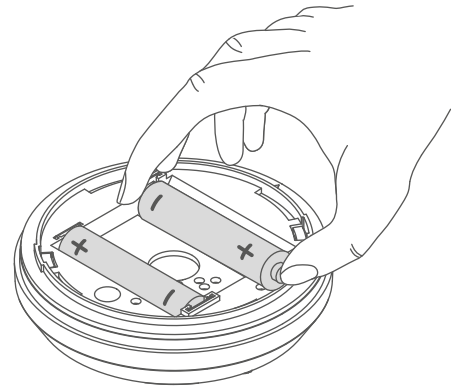

Figure 4

Please pay attention to the flashing signals of the device LED while inserting the batteries ([see Flash codes, page 9](#)). Replace the cap on the electronic unit and tighten.

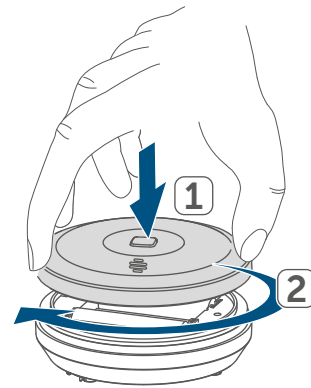

Figure 5

Once the batteries have been inserted, the water sensor will perform a self-test/restart (approx. 2 seconds). Afterwards, initialisation is carried out. The LED test display will indicate that initialisation is complete by lighting up orange and green.



Caution! There is a risk of explosion if the battery is not replaced correctly. Replace only with the same or equivalent type. Never recharge standard batteries. Do not throw the batteries into a fire. Do not expose batteries to excessive heat. Do not short-circuit batteries. Doing so will present a risk of explosion.

is not usually reached. However, repeated and radio-intensive pairing processes mean that it may be reached in isolated instances during start-up or initial installation of a system. If the duty cycle is exceeded, this is indicated by three slow red flashes of the LED, and may manifest itself in the device temporarily not working. The device will start working again after a short period (max. 1 hour).

8 Troubleshooting

8.1 Command not confirmed

If at least one receiver does not confirm a command, the LED lights up red at the end of the failed transmission.

The reason for the failed transmission may be radio interference [*see General information about wireless operation, page 10*](#). This may be caused by the following:

- Receiver cannot be reached
- Receiver is unable to execute the command (load failure, mechanical blockage, etc.)
- Receiver is faulty

8.2 Duty cycle

The duty cycle is a legally prescribed limitation of the transmission time of devices in the 868 MHz range. The aim of this regulation is to safeguard the operation of all devices working in the 868 MHz range. In the 868 MHz frequency range used by us, the maximum transmission time of any device is 1% of an hour (i.e. 36 seconds in an hour). Devices must cease transmission when they reach the 1% limit until this time restriction expires. Homematic IP devices are developed and produced to ensure 100% conformity with this regulation.

During normal operation, the duty cycle

8.3 Flash codes

Flash code	Meaning	Solution
1x orange and 1x green light (after inserting the batteries)	Test display	You can continue once the test display has stopped.
Short orange flashes (every 10 s)	Pairing mode active	Enter the last four digits of the device number (SGTIN) in your app, or scan the QR code.
Fast orange flashing	Direct pairing mode active	Enable pairing mode of the device to be paired— see <i>Direct pairing with a Homematic IP device (push-to-pair)</i> .
Short orange flashes	Transmission of configuration data	Wait until the transmission is completed.
Brief orange flashing (followed by a steady green light)	Transmission confirmed	You can continue operation.
Brief orange flashing (followed by a steady red light)	Operation failed or duty cycle limit reached	Please try again see <i>Command not confirmed, page 8</i> or see <i>Duty cycle, page 8</i> .
6x long red flashes	Error detected	Please see the display on your app or contact your retailer.
Short orange light (after green or red light) Short repeated beeping	Battery/batteries empty	Replace the device battery/batteries see <i>Changing the batteries</i> .
Alternating long and short orange flashing	Device software update (OTAU)	Wait until the update is completed.

9 Restoring the factory settings

-  The factory settings of the device can be restored. If the device is paired with a control unit, the configurations are automatically restored. If the device is not paired with a control unit, all the settings are lost.

Proceed as follows to restore the factory settings of the device:

- Remove one battery from the battery compartment.
- Please wait a minute.
- Press and hold the system button for 4 seconds [Fig. 2](#) and insert the battery at the same time. Pay attention to the correct polarity marking
- The device LED starts flashing orange fast.
- Release the system button .
- Press and hold the menu button for 4 seconds.
- The device LED lights up green.
- Release the system button to finish restoring the factory settings.

The device performs a restart.

-  If the device LED lights up red to, please try again [Flash codes, page 9](#).

10 Maintenance and cleaning

-  The device is maintenance-free for you, except for any necessary battery changes. Leave any maintenance or repair to a specialist.

Clean the device using a soft, clean, dry and lint-free cloth. The cloth can be slightly dampened with lukewarm water to remove more stubborn marks. Do not

use any detergents containing solvents for cleaning purposes. They could corrode the plastic housing and label.

11 General information about wireless operation

Radio transmission is performed on a non-exclusive transmission path, which means that there is a possibility of interference occurring. Interference can also be caused by switching operations, electrical motors or defective electrical devices.

-  The range inside buildings can differ greatly from that in open air. Besides the transmitting power and the reception characteristics of the receiver, environmental factors such as humidity in the vicinity play an important role, as do on-site structural/screening conditions.

Declaration of conformity

eQ-3 AG, Maiburger Str. 29, 26789 Leer, Germany, hereby declares that the wireless system type Homematic IP HmIP-SWD-2 complies with Directive 2014/53/EU. The full text of the EU declaration of conformity can be found at: www.homematic-ip.com

12 Disposal



This symbol means that the device and the single-use or rechargeable batteries must not be disposed of as household waste or general waste, or in a yellow bin or yellow bag. For the protection of health and the environment, you must take the product, all electronic parts included in the package contents, and the batteries to a municipal collection point for waste electrical and electronic equipment to ensure correct disposal of the same. Distributors of electrical and electronic equipment or batteries must also take back waste equipment or used batteries free of charge. By disposing of them separately, you are making a valuable contribution to the reuse, recycling and other methods of recovery of used devices and used batteries. You must separate any used single-use and rechargeable batteries found in used electrical and electronic devices from the used device if they are not enclosed by the used device before handing it over to a collection point and dispose of them separately at the local collection points. Please also remember that you, the end user, are responsible for deleting personal data on any waste electrical and electronic equipment before disposing of it.

CE The CE mark is a free trademark that is intended exclusively for the authorities and does not imply any assurance or guarantee of properties.



If you have any technical questions about the appliance, please contact your specialist dealer.

13 Technical specifications

Device short name	HmIP-SWD-2
Supply voltage	2× 1.5 V LR03/micro/AAA
Battery life	5 years (typical)
Current consumption	100 mA
Degree of pollution	2
Volume integrated siren	Approx. 77 dB (at a distance of 1 m)
Degree of protection	IP44
Ambient temperature	-20 - +55°C
Dimensions (Ø × H)	80 x 30 mm
Weight (incl. batteries)	78 g
Typical Range in open space	230 m
Radio frequency band	868,0-868,6 / MHz 869,4-869,65 MHz
Duty cycle	< 1 % pro h / < 10 % pro h
Receiver category	SRD category 2
Maximum radiated power	10 dBm

Subject to modifications.

Free download of the Homematic IP app!



Bevollmächtigter des Herstellers:
Manufacturer's authorised representative:

eQ-3

eQ-3 AG
Maiburger Straße 29
26789 Leer / GERMANY
www.eQ-3.de