

# Wall-mount Remote Control for brand switches – 2 channels

HmIP-BRC2-2



## Table of contents

|   |    |
|---|----|
| 1 Package contents.....   | 3  |
| 2 Information about this manual.....                              | 3  |
| 3 Hazard information.....   | 3  |
| 4 General system information.....                                 | 5  |
| 5 Function and device overview.....                               | 5  |
| 6 Start-up.....   | 6  |
| 6.1 Installation instructions.....                                | 6  |
| 6.2 Assembly and installation.....                                | 7  |
| 6.3 Adapters for brand switch systems.....                        | 8  |
| 6.4 Pairing with a control unit.....                              | 8  |
| 6.5 Direct pairing with a Homematic IP device (push-to-pair)..... | 9  |
| 7 Operation.....  | 10 |
| 8 Troubleshooting.....  | 11 |
| 8.1 Command not confirmed.....                                    | 11 |
| 8.2 Duty cycle.....   | 11 |
| 8.3 Flash codes.....  | 12 |
| 9 Restoring the factory settings.....                             | 13 |
| 10 Maintenance and cleaning.....                                  | 13 |
| 11 General information about wireless operation.....              | 13 |
| 12 Disposal.....  | 14 |
| 13 Technical specifications.....                                  | 15 |

## 1 Package contents

1x Wall-mount Remote Control for brand switches – 2 channels  
2x Screws (3.2 x 15 mm)  
2x Screws (3.2 x 25 mm)  
Operating manual

## 2 Information about this manual

Read this manual carefully before beginning operation with your Homematic IP device. Keep the manual for later consultation. If you hand the device over to other persons for use, please ask them to read this manual.

### Symbols used

 This indicates a hazard.

 This section contains important additional information.

## 3 Hazard information

 We accept no liability for damage caused by use for other than the intended purpose, incorrect handling or failure to observe the hazard warnings. In such cases, all warranty claims are void. We accept no liability for consequential damage.

 Do not use the device if it has visible damage or a malfunction. If you have any doubts, have the device checked by a qualified expert.

 For safety and licensing reasons (CE), unauthorised conversions to and/or modification of the device are not permitted.

 The device is not a toy – do not allow children to play with it.



 Plastic film, plastic bags, polystyrene parts, etc. can be dangerous for children. Keep the packaging material out of the reach of children and dispose of it immediately.

 Clean the device using a soft and clean lint-free cloth. Do not use any detergents containing solvents for cleaning purposes.

 Do not expose the device to moisture, vibrations, constant solar or other heat radiation, excessive cold or mechanical loads. The device must only be operated indoors.

 The device may only be installed in the following device boxes:

- in commercially available switch sockets (device boxes) in accordance with DIN 49073-1

  Failure to observe the installation instructions may result in fire or a danger of electric shock. The device is part of the building installation. Observe the relevant national standards and directives during planning and installation.

 The device may only be operated on a 230 V~/50 Hz AC mains power supply. Work on the 230 V mains may only be carried out by a qualified electrician (in accordance with VDE 0100).

 Observe the permissible cable types and conductor cross sections when connecting to the device terminals.



The circuit to which the device is connected must be protected by a circuit breaker in accordance with DIN EN 60898-1 (tripping characteristic B or C, max. 16 A rated current, min. 6 kA interrupting rating, energy limiting class 3). The installation regulations in accordance with VDE 0100 and HD384 or IEC 60364 must be observed. The circuit breaker must be easily accessible to the user and marked as the disconnecting device for the actuator.

## 4 General system information

This device is part of the Homematic IP smart home system and communicates via the Homematic IP radio protocol. The device can be paired directly with one or more Homematic IP devices in order to control them directly (push-to-pair). Alternatively, the device can be paired with a control unit and configured via the Homematic IP app. All devices of the system can be configured comfortably and individually using the Homematic IP app. Operation requires the connection to a Homematic IP Access Point or control unit. Further information about the system and how to combine it with other Homematic IP devices can be found in the Homematic IP [User guide](#).

All technical documents and updates are to be found at [www.homematic-ip.com](http://www.homematic-ip.com).

## 5 Function and device overview

The Homematic IP Wall-mount Remote Control for brand switches has two rocker switches and can be used flexibly in the Homematic IP system to control devices and functions.

The device can be installed in a free device box or replace existing switches if there is a neutral conductor in the switch box in addition to the phase

The buttons enable the convenient control of devices and system functions within your smart home: for example, switching light sources on and off, activating and deactivating Eco mode, and raising and lowering roller shutters.

Adapters for different switches allow you to replace switches made by popular manufacturers in a cost-effective way. Using existing or planned switches and

cabling reduces the cost of installation to a minimum. The design, colour and finish of already installed switches remain the same since existing frames and rockers can continue to be used.



The device may only be installed in the following device boxes:

- in commercially available switch sockets (device boxes) in accordance with DIN 49073-1

### Device overview

- System button (device LED)
- Connecting terminal for L ↑ (phase conductor)
- Connecting terminal for N (neutral conductor)

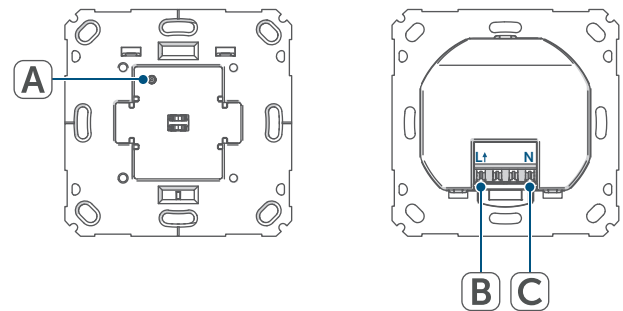

Figure 1

### Installation overview

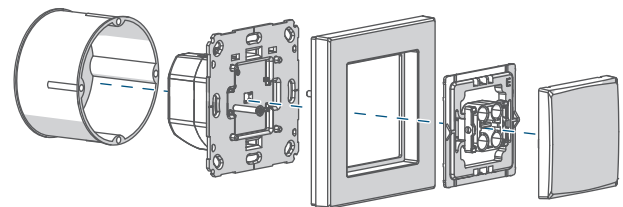





Figure 2

## 6 Start-up

### 6.1 Installation instructions

 Read this section completely before starting installation.

 Make a note of the device number (SGTIN) and the installation location of the device before installation to make it easier to identify the device later. The device number can also be found on the enclosed QR code sticker.

 Please observe the hazard warnings during installation [see Hazard information, page 3](#).

 Please note the insulation stripping length of the conductor being connected, as indicated on the device.

 The device may only be installed in the following device boxes:

- in commercially available switch sockets (device boxes) in accordance with DIN 49073-1

 The device may only be operated with adapters and the relevant, fitted switch cover. The switch cover may only be removed during configuration.

 It is absolutely essential to ensure that the connecting cables are laid so that they are physically separate from cables carrying mains voltage (e.g. in separate cable ducts or wiring conduits).

If changes to or work on the house installation are necessary (e.g. extension, bypass of switch or socket inserts) or to/on the low-voltage distribution system for mounting or installing the device, the following safety instructions must be observed:

 Only to be installed by persons with the relevant electro-technical knowledge and experience! \*

Incorrect installation can endanger

- your own life,
- and the lives of other users of the electrical system.

Incorrect installation also means that you are running the risk of serious damage to property, e.g. due to fire. You risk personal liability for personal injury and property damage.

#### **\*Specialist knowledge required for installation:**

The following specialist knowledge is particularly important during installation:

- The "5 safety rules" to be used:
  - Disconnect from mains
  - Secure against restart
  - Check for absence of voltage
  - Earth and short circuit
  - Cover or cordon off neighbouring live parts
- Selection of suitable tools, measuring equipment and, if necessary, personal protective equipment;
- Evaluation of measuring results;
- Selection of electrical installation material for safeguarding shut-off conditions;
- IP protection types;

- Installation of electrical installation material;
- Type of supply network (TN system, IT system, TT system) and the resulting connection conditions (classic zero balancing, protective earthing, required additional measures, etc.).

**Permitted cable cross sections for connecting to the device are:**

rigid cable, 0.75 - 1.5 mm<sup>2</sup>  
 flexible cable (with and without ferrule),  
 0.75 - 1.5 mm<sup>2</sup>

**6.2 Assembly and installation**

Proceed as follows to install the device:

- Switch off the circuit breaker of the power circuit.
- Pull the rocker off the frame of the relevant switch.
- Then pull the frame off the switch together with the clamping / retaining piece. The clamping/retaining piece can be transparent, grey or black depending on the manufacturer, and holds the frame onto the switch.
- Loosen the fixing of the existing switch on the switch box and carefully pull the switch out.
- Release the wiring and remove the existing switch.

**i** To make removal easier, a slotted screwdriver, for example, can be used.

- Connect the phase conductor to connecting terminal L.
- Connect the neutral conductor to connecting terminal N.

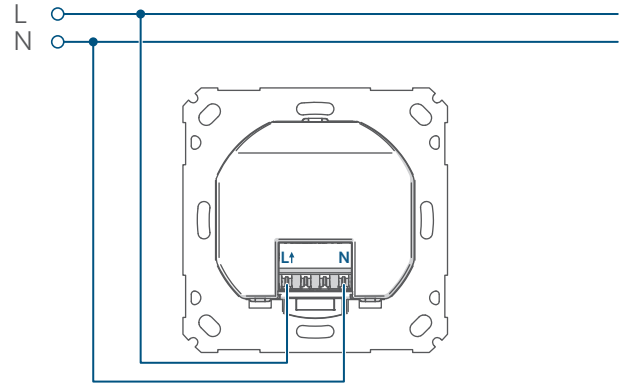

Figure 3

- Place the device into the switch box.

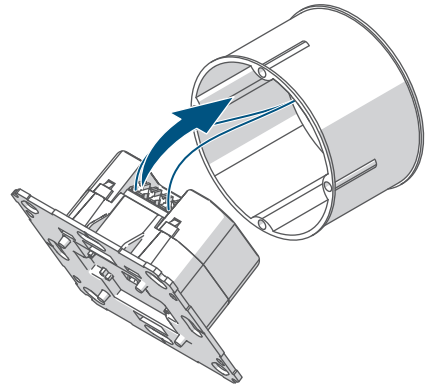

Figure 4

- Secure the device using the provided screws into the switch box.

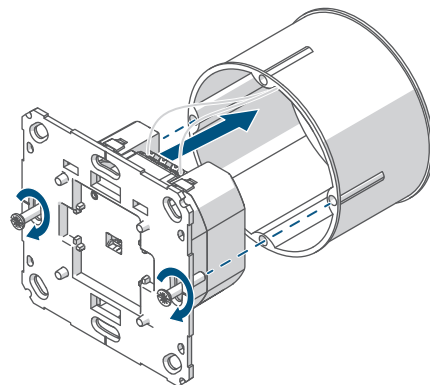

Figure 5

- Place the frame of your installation onto the device.

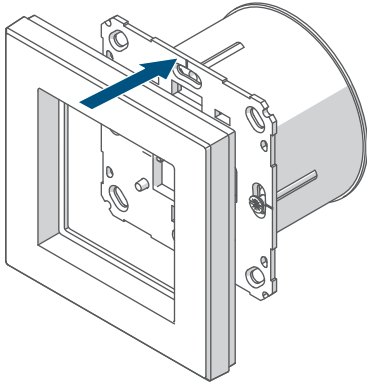

Figure 6

- Place the rocker switch from your switch series onto the adapter.

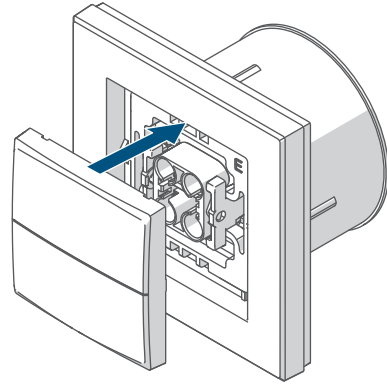

Figure 8

- Fit the appropriate brand switch adapter to the device by fully engaging the connecting pins in the holder provided on the device.

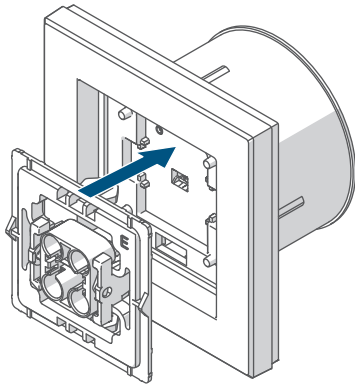

Figure 7

- Switch the circuit breakers of the power circuit back on to activate the pairing mode of the device.
- The device is now ready for operation and can be connected to a Homematic IP control unit or another Homematic IP device ([see Pairing](#)).

### 6.3 Adapters for brand switch systems

To achieve compatibility with as many manufacturers as possible and make integration in different designs easier, different rocker adapters are available as accessories.

A separate list on compatibility with standard switch series can be found in the website download area [Overview of switch series](#).

### 6.4 Pairing with a control unit

-  Read this entire section before starting the pairing procedure.

- i** Set up your Homematic IP control unit via the Homematic IP app so that you can use Homematic IP devices in the system. Detailed information on this is to be found in the operating manual for the control unit.

Proceed as follows to pair the device with your control unit:

- Open the Homematic IP app.
- Tap on **...More** in the homescreen.
- Tap on **Pair device**.
- Connect the power supply.
- The pairing mode is active for 3 minutes.

- i** You can manually start the pairing mode for another 3 minutes by pressing the system button shortly.

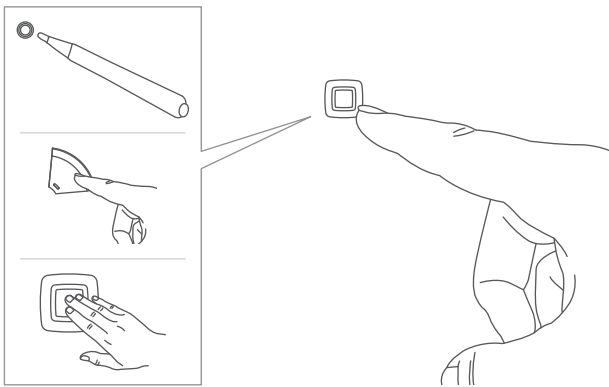

Figure 9

- i** The type of system button depends on your device. Further information is to be found in the device overview.

- The device appears automatically in the Homematic IP app.
- Enter the last four digits of the device number (SGTIN) in your app, or scan the QR code. The device number can be found on the sticker supplied or attached to the device.
- Wait until pairing is completed.
- If pairing was successful, the device LED lights up green.
- The device is now ready for use.

- i** If the device LED lights up red to, please try again [Flash codes, page 12](#).

- Then follow the instructions in the Homematic IP app.

## 6.5 Direct pairing with a Homematic IP device (push-to-pair)

- i** Read this entire section before starting the pairing procedure.
- i** Detailed information on push-to-pair and combining with other Homematic IP devices can be found at [www.homematic-ip.com/en/push-to-pair](http://www.homematic-ip.com/en/push-to-pair)
- i** If you have already paired the device directly with another Homematic IP device, you must first restore the factory settings to pair it with a Homematic IP control unit [see Restoring the factory settings, page 13](#).
- i** Please make sure you maintain a distance of at least 50 cm between the devices during pairing.

- i** You can leave the pairing mode manually by briefly pressing the system button. This will be indicated by the device LED lighting up red.

Proceed as follows to pair a device with another Homematic IP device:

- Connect the power supply.
- Press and hold the system button for 4 s.
- The device LED starts flashing orange fast.
- Release the system button.
- The pairing mode remains activate for 3 minutes.
- Press and hold the system button of the device to be paired for 4 seconds.
- The device LED starts flashing orange fast.
- Release the system button.
- The device LED lights up green to indicate that pairing has been successful.

- i** If the device LED lights up red to, please try again [Flash codes, page 12](#).

- i** If no pairing is performed, the pairing mode is automatically cancelled after 3 minutes.

- i** If you are using several devices in one room, you should pair all devices with each other.

- **Button press:** You can switch paired actuators on/off at the touch of a button. By default, the top button switches the actuator off and the bottom button switches the actuator on.

If you have paired the device with a Homematic IP Central Control Unit, additional configurations are available in the device settings:

- **Pair of buttons/single buttons:** You can configure the buttons on the device.

- Button pairs
- Single buttons

By default, the buttons are configured as button pairs.

Define the function of the buttons in the Homematic IP App according to your personal requirements, e.g. to switch light sources on/off, activate/deactivate Eco mode or raise/lower shutters.

- **Double-click function:** The double-click function prevents actions being triggered unintentionally. If you have activated the double-click function, an action is only carried out with a double-click. Specify the time span in which the second click must take place.
  - Activate (0.1 - 1 s)
  - Deactivate

## 7 Operation

After set-up, simple operations are available directly on the device.

## 8 Troubleshooting

### 8.1 Command not confirmed

If at least one receiver does not confirm a command, the LED lights up red at the end of the failed transmission.

The reason for the failed transmission may be radio interference [see \*General information about wireless operation, page 13\*](#). This may be caused by the following:

- Receiver cannot be reached
- Receiver is unable to execute the command (load failure, mechanical blockage, etc.)
- Receiver is faulty

### 8.2 Duty cycle

The duty cycle is a legally regulated limit of the transmission time of devices in the 868 MHz range. The aim of this regulation is to safeguard the operation of all devices working in the 868 MHz range. In the 868 MHz frequency range we use, the maximum transmission time of any device is 1% of an hour (i.e. 36 seconds in an hour). Devices must cease transmission when they reach the 1% limit until this time restriction ends. Homematic IP devices are designed and produced with 100% conformity to this regulation.

During normal operation, the duty cycle is not usually reached. However, repeated and radio-intensive pairing processes mean that it may be reached in isolated instances during start-up or initial installation of a system. If the duty cycle is exceeded, this is indicated by three slow red flashes of the device LED, and may manifest itself in the device temporarily working incorrectly. The device will start working correctly again after a short period (max. 1 hour).

### 8.3 Flash codes

| Flash code   | Meaning   | Solution   |
|--|---|--|
| 1x orange and 1x green light (after connecting the power supply) | Test display                                    | You can continue once the test display has stopped.  |
| Short orange flashes (every 10 s)                                | Pairing mode active                             | Enter the last four digits of the device number (SGTIN) in your app, or scan the QR code.  |
| Fast orange flashing   | Direct pairing mode active                      | Enable pairing mode of the device to be paired— <a href="#">see <i>Direct pairing with a Homematic IP device (push-to-pair)</i>, page 9.</a> |
| Short orange flashes   | Transmission of configuration data              | Wait until the transmission is completed.  |
| Brief orange flashing (followed by a steady green light)         | Transmission confirmed                          | You can continue operation.  |
| Brief orange flashing (followed by a steady red light)           | Transmission failed or duty cycle limit reached | Please try again <a href="#">see <i>Command not confirmed</i>, page 11</a> or <a href="#">see <i>Duty cycle</i>, page 11.</a>                |
| 6x long red flashes  | Device defective                                | Please see the display on your app or contact your retailer.   |
| Alternating long and short orange flashing                       | Device software update (OTAU)                   | Wait until the update is completed.  |

## 9 Restoring the factory settings

- i** The factory settings of the device can be restored. If the device is paired with a control unit, the configurations are automatically restored. If the device is not paired with a control unit, all the settings are lost.

Proceed as follows to restore the factory settings of the device:

- Press and hold the system button for 4 seconds [Fig. 9](#)
- The device LED starts flashing orange fast.
- Release the system button .
- Press and hold the menu button for 4 seconds.
- The device LED lights up green.
- Release the system button to finish restoring the factory settings.

The device performs a restart.

- i** If the device LED lights up red to, please try again [Flash codes, page 12](#).

## 10 Maintenance and cleaning

- i** The device is maintenance-free for you. Leave any maintenance or repair to a specialist.

Clean the device using a soft, clean, dry and lint-free cloth. The cloth can be slightly dampened with lukewarm water to remove more stubborn marks. Do not use any detergents containing solvents for cleaning purposes. They could corrode the plastic housing and label.

## 11 General information about wireless operation

Radio transmission is performed on a non-exclusive transmission path, which means that there is a possibility of interference occurring. Interference can also be caused by switching operations, electrical motors or defective electrical devices.

- i** The range inside buildings can differ greatly from that in open air. Besides the transmitting power and the reception characteristics of the receiver, environmental factors such as humidity in the vicinity play an important role, as do on-site structural/screening conditions.

### Declaration of conformity

eQ-3 AG, Maiburger Str. 29, 26789 Leer, Germany, hereby declares that the wireless system type Homematic IP HmIP-BRC2-2 complies with Directive 2014/53/EU. The full text of the EU declaration of conformity can be found at: [www.homematic-ip.com](http://www.homematic-ip.com)

## 12 Disposal



This symbol means that the device must not be disposed of as household waste, general waste, or in a yellow bin or a yellow sack. For the protection of health and the environment, you must take the product and all electronic parts included in the scope of delivery to a municipal collection point for waste electrical and electronic equipment to ensure their correct disposal. Distributors of electrical and electronic equipment must also take back waste equipment free of charge. By disposing of it separately, you are making a valuable contribution to the reuse, recycling and other methods of recovery of old devices. Please also remember that you, the end user, are responsible for deleting personal data on any waste electrical and electronic equipment before disposing of it.

**CE** The CE mark is a free trademark that is intended exclusively for the authorities and does not imply any assurance or guarantee of properties.



If you have any technical questions about the appliance, please contact your specialist dealer.

## 13 Technical specifications

|   |   |
|---|---|
| Short description                       | HmIP-BRC2-2   |
| Supply voltage                          | 230 V / 50 Hz   |
| Protection class                        | II  |
| Degree of protection                    | IP20  |
| Ambient temperature                     | 5 - 35°C  |
| Weight                                  | 47 g  |
| Dimensions (W × H × D)                  | 71 x 71 x 37 mm   |
| Current consumption                     | 10 mA max.  |
| Standby power consumption               | 0.2 W   |
| Cable type and cross section rigid wire | rigid cable, 0.75 - 1.5 mm <sup>2</sup>                       |
| Installation                            | in switch boxes (device boxes) in accordance with DIN 49073-1 |
| Typical Range in open space             | 240 m   |
| Radio frequency band                    | 868.0–868.6 MHz / 869.4–869.65 MHz                            |
| Duty cycle                              | <1% per h / <10% per h  |
| Receiver category                       | SRD category 2  |
| Maximum radiated power                  | 10 dBm  |

**Subject to modifications.**

# Free download of the Homematic IP app!



Bevollmächtigter des Herstellers:  
Manufacturer's authorised representative:

**eQ-3**

eQ-3 AG  
Maiburger Straße 29  
26789 Leer / GERMANY  
www.eQ-3.de